

UNDERFLOOR HEATING FOR 3 ROOMS AND BOILER CONTROL

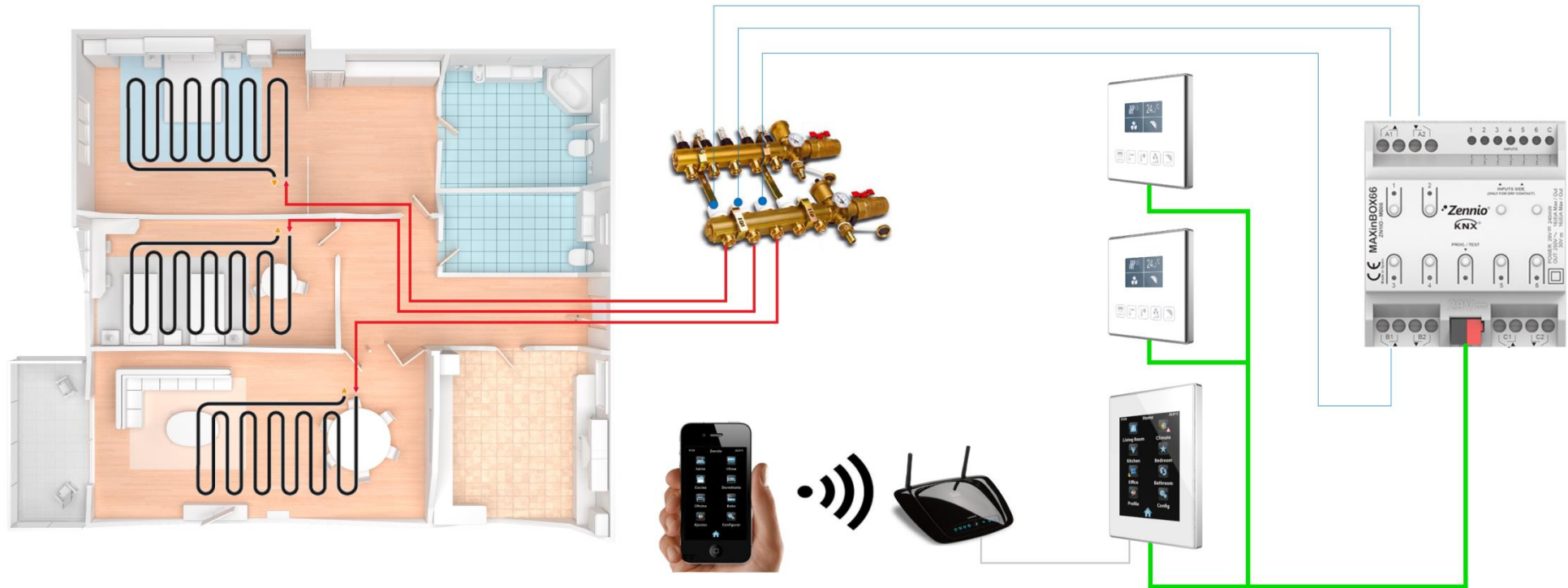

ROOM CONTROLLERS

- Switch On/Off
- Setpoint.
- Chrono-thermostats.
- Internal temperature probe.
- Remote control by **Smartphone**.

THERMOSTATIC CONTROL

- Valve opening regulation using pulse width modulation.
- Control: PI control - PWM 1 bit – On/Off valves.

VALVES CONTROLLER

- Floor heating valves opening and closing.
- Boiler on/off according to zones demand.

IMPORTANT: When checking ETS Project activating the option “! Show changes” on parameter tab the symbol “!” will appear showing the modified parameters on ETS.



NEEDED DEVICES AND WIRING DIAGRAM

ZPS160MPA

KNX Power Supply
REF: ZN1PS-160MPA

MAXinBOX 66

Multifunction actuator
6 outputs / 6 inputs
REF: ZN1IO-MB66

InZennio Z41

KNX capacitive color touch panel
REF: ZN1VI-TP41C

Square TMD-Display

Capacitive touch panel with 5 buttons and
upper graphical display with thermostat.
REF: ZVI-SQTMDD

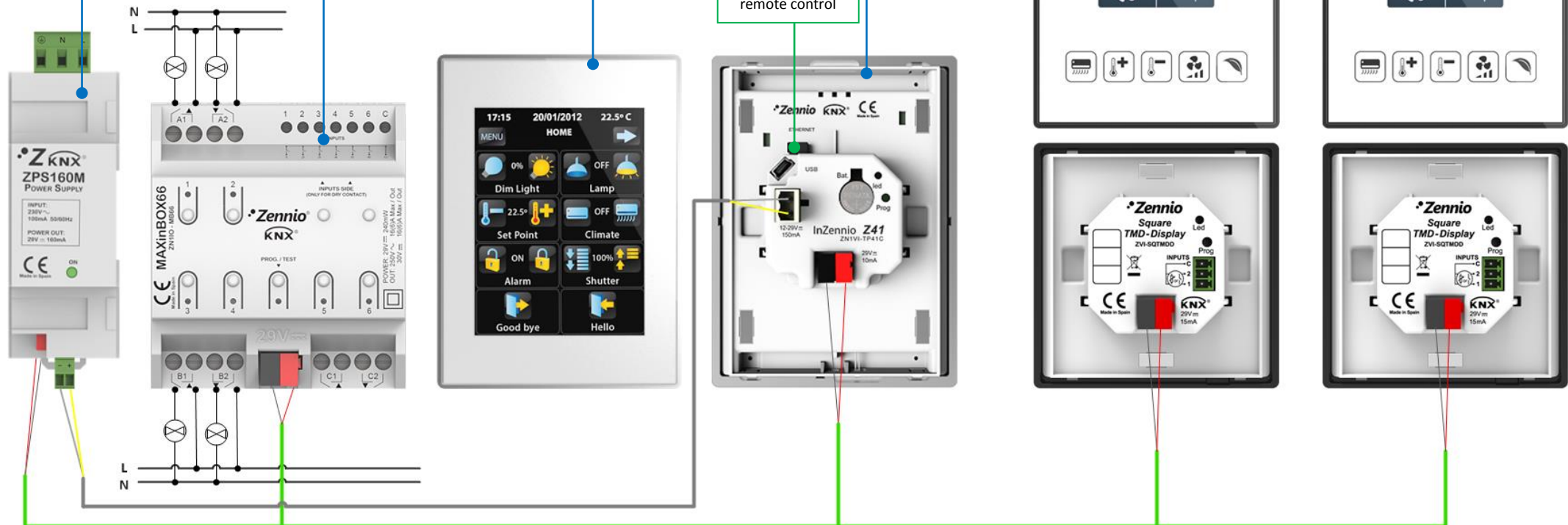

KNX COMMUNICATION OBJECTS

ROOM CONTROLLER

THERMOSTATS

ACTUATOR

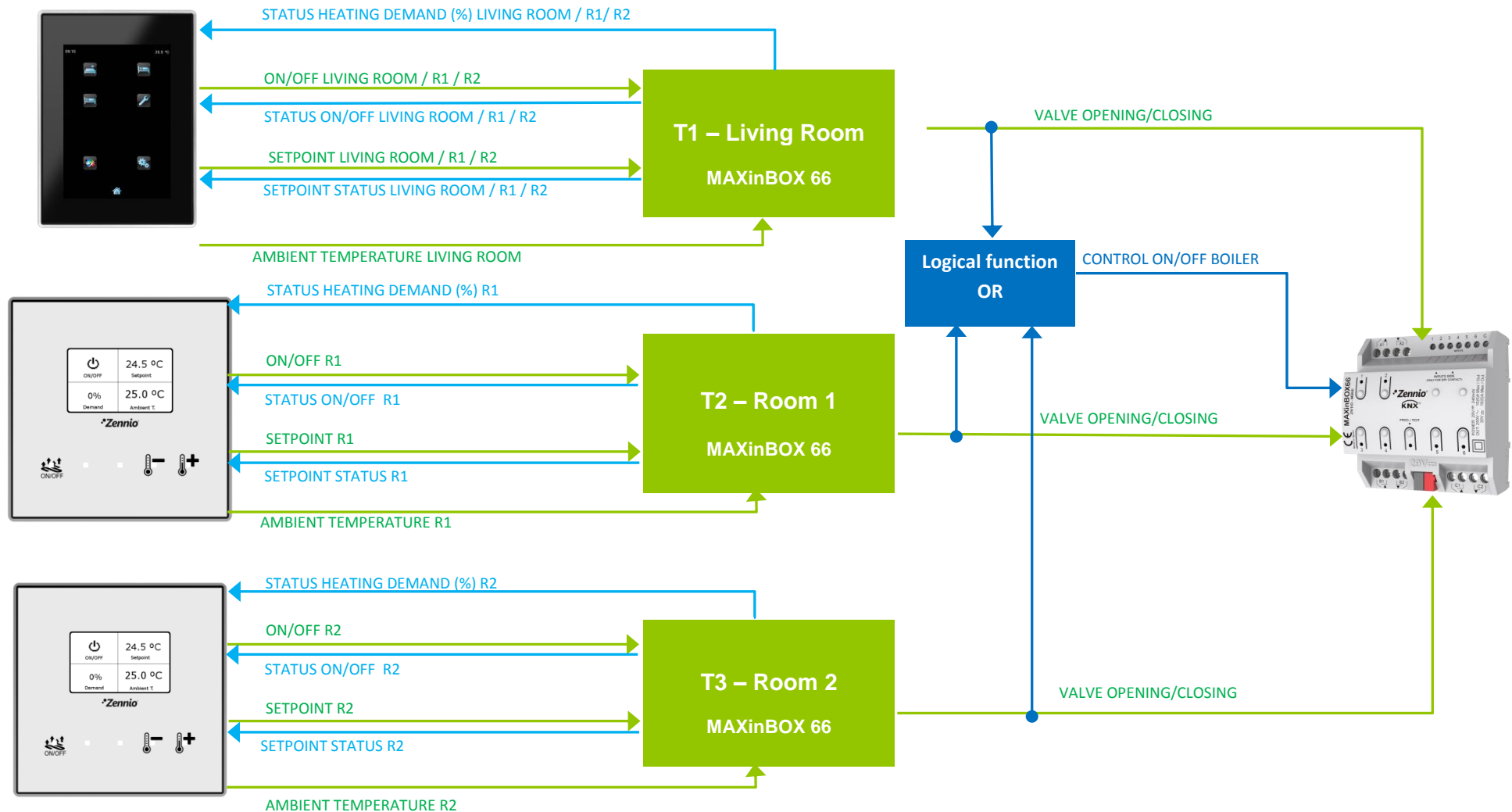

ROOM CONTROLLER

ROOMS 1 and 2

Operating status indicator

 Floor heating ON

 Floor heating OFF

Heating demand

Setpoint status

Ambient temperature status

Floor heating On/Off control.

Setpoint control.
Step: +/- 0,5 °C.

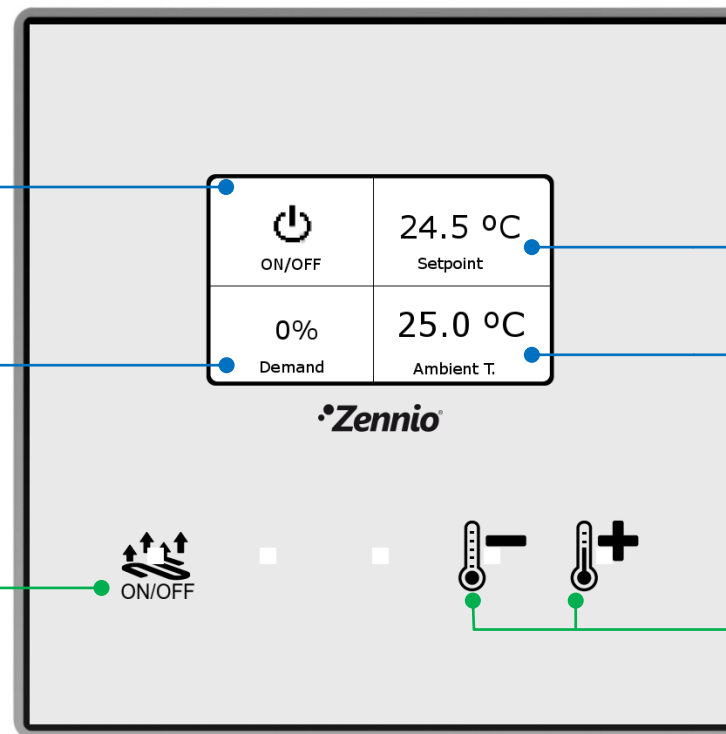

CENTRALISED CONTROL

HOME PAGE

Access to zone control pages and boiler page.

LIVING ROOM /ROOM 1 / ROOM 2

Zone control page

Zone control



Heating on
Heating off

Setpoint control



- 0,5 °C
+ 0,5 °C

CHRONO-THERMOSTAT

Chrono-thermostat control



Control disable/enable
chrono-thermostat.
Access to chrono-thermostat
page

BOILER

Boiler status and zones demand display

Boiler status



Boiler on
Boiler off

Valves status



Valve open
Valve closed



PROFILE

CONFIG

Heating demand



HOME

Back to home
page.

Current temperature

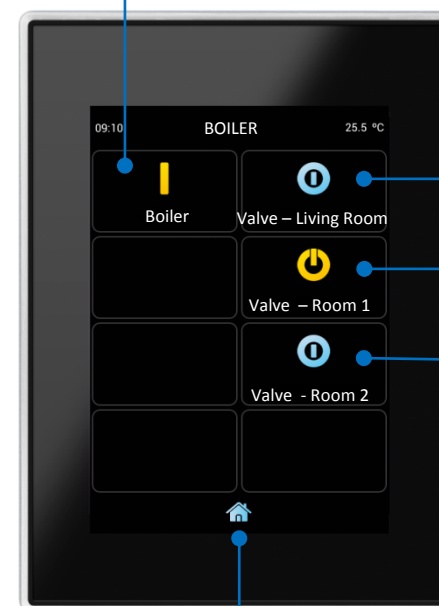
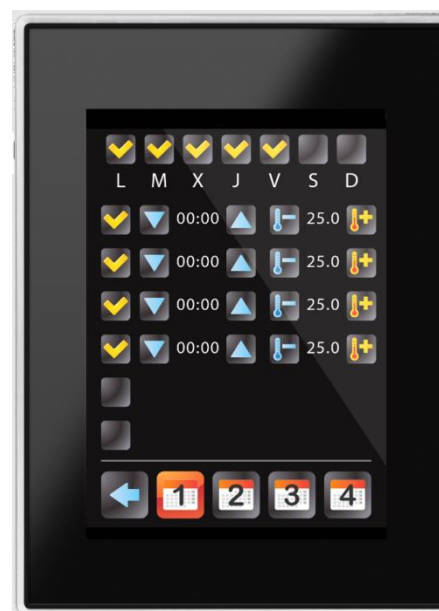

HOME

Back to home page.

ALTERNATIVE PRODUCTS

ROOM CONTROLLER ALTERNATIVES



InZennio Z41 (Ref. ZN1VI-TP41)
KNX capacitive color touch panel.



TMD-Display One (Ref. ZVI-TMDD)
KNX capacitive room controller.



InZennio Z38i (Ref. ZN1VI-TP38i)
Monochrome touch panel KNX.



Roll-ZAS (Ref. ZN1VI-TPZAS)
Touch controller.



Z41 Lite (Ref. ZVI-Z41LIT)
Full color capacitive touch panel lite.

ACTUATOR ALTERNATIVES



MAXinBOX 16 Plus
(Ref. ZN1IO-MB16P)
Multifunction
actuator – 16
outputs.



ACTinBOX CLASSIC HYBRID
(Ref. ZN1IO-AB46A)
Multifunction actuator 4
outputs / 6 inputs.



ACTinBOX QUATRO
(Ref. ZN1IO-AB40)
Multifunction actuator 4
outputs.



MAXinBOX 8
(Ref. ZN1IO-MB8)
Multifunction
actuator 8 outputs.



ACTinBOX MAX 6
(Ref. ZN1IO-AB60)
Multifunction actuator 6
outputs.



MINiBOX 25 (Ref. ZIO-MN25)
Multifunction actuator
with 2 outputs (16A) and 5
analog-digital inputs

COMING SOON



HeatingBOX 230V 8X
(Ref. ZCL-4HT230)
Heating actuator for up to 8
outputs 230VAC.

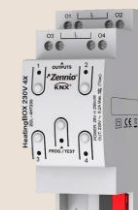

HeatingBOX 230V 4X
(Ref. ZCL-4HT230)
Heating actuator for up to 4
outputs 230VAC.